

**28MM 720X320 CM ZDDDC02 (ART 3802EXT)**

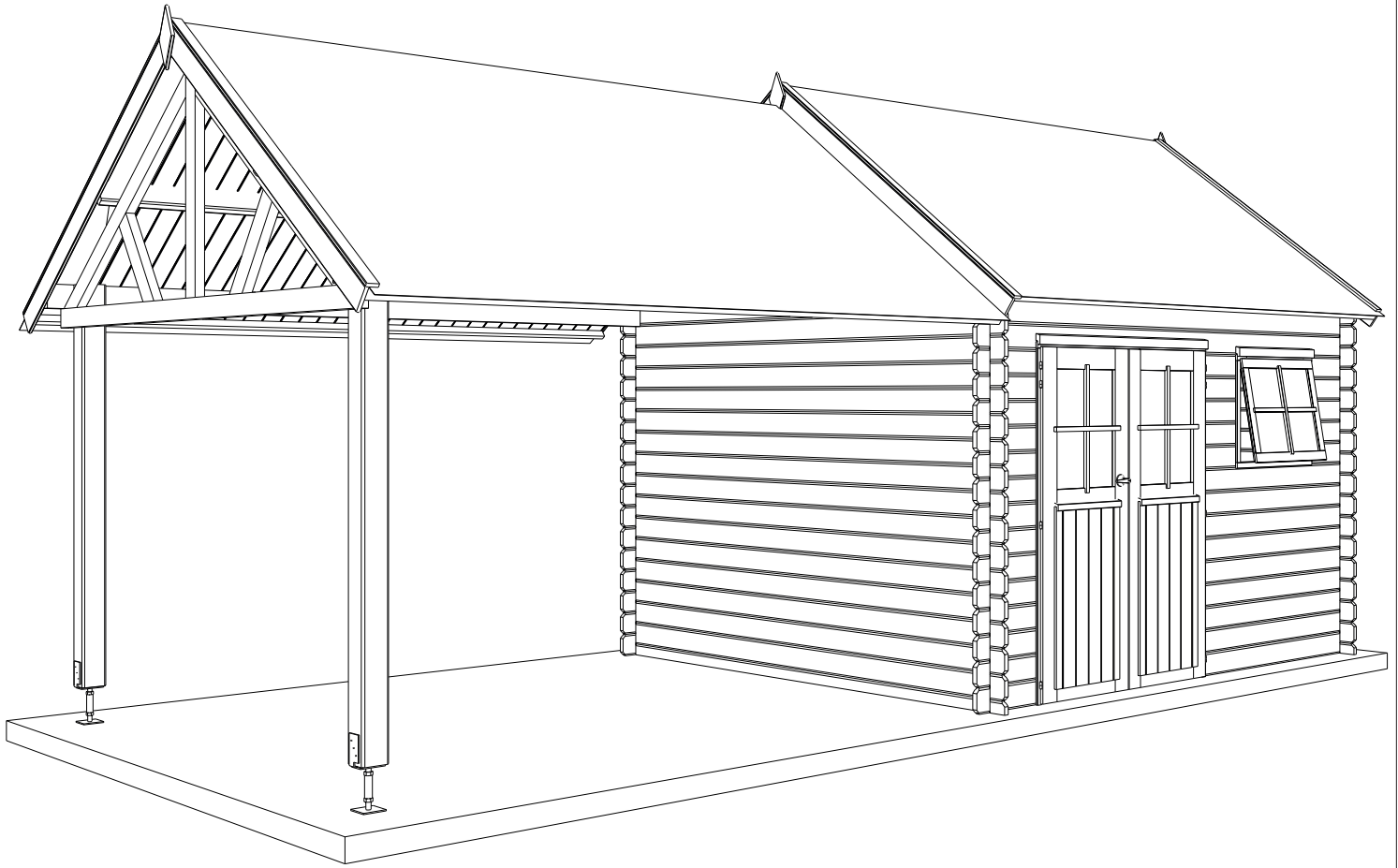

# **WOODLANDS**

**QUALITY CABINS**

**GEDETAILEERDE ONDERDELENLIJST**  
-  
**LISTE D'INVENTAIRE DETAILLEE**

# Onderdelenlijst Liste d'inventaire

# Typ diamond **28mm 355x320 cm ZDDDC01**

## 3802

Artikel nr / N° Article      Afmeting / Dimension      #      Functie / Fonction  
A      B      C

### Wandelementen / Éléments des parois

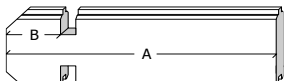

C1/0478/0100	478	100	(-)	<b>19</b>	naast raam & deur voorgevel / côté fenêtre & porte façade
C1/1600/0100	1600	100	(-)	<b>9</b>	onder raam voorgevel / sous fenêtre façade

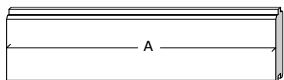

A2/0344	344	(-)	(-)	<b>5</b>	tussen raam & deur voorgevel / entre fenêtre & porte façade
---------	-----	-----	-----	----------	---

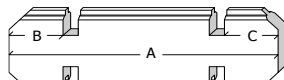

C3/3550/0100/0100	3550	100	100	<b>15</b>	achtergevel / paroi arrière
C3/3200/0100/0100	3200	100	100	<b>30</b>	zijgevel / paroi latérale

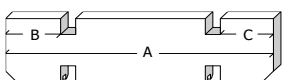

C5/3550/0100/0100	3550	100	100	<b>2</b>	bovenste plank achter- & voorgevel / planche supérieure paroi arrière & façade
-------------------	------	-----	-----	----------	---

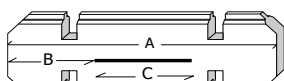

C8/3550/QQ001	3550	478	1472	<b>1</b>	boven deur / au-dessus porte
---------------	------	-----	------	----------	------------------------------

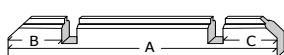

C7/3200/0100/0100	3200	100	100	<b>2</b>	basis zijgevel / base paroi latérale
-------------------	------	-----	-----	----------	--------------------------------------

### Dakelementen / Éléments du toit

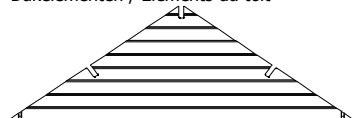

CK/S9/3200/3/4	3200	(-)	(-)	<b>2</b>	puntgevel te assembleren / pignon à assembler
----------------	------	-----	-----	----------	---

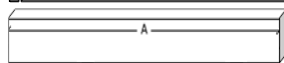

P4/3550	3550	120	44	<b>3</b>	dakbalk / poutre du toit
---------	------	-----	----	----------	--------------------------



DP/2080	2080	(-)	(-)	<b>62</b>	dakplanchet / planchette du toit
---------	------	-----	-----	-----------	----------------------------------

### Afwerkingselementen / Éléments de finition



SRD/0807	807	(-)	(-)	<b>2</b>	sierlat boven raamkader / latte de finition cadre de fenêtre
SRD/1502	1502	(-)	(-)	<b>2</b>	sierlat boven deurkader / latte de finition cadre de porte



FSL/2100	2100	(-)	(-)	<b>4</b>	frontale sierlat / latte de finition frontale
----------	------	-----	-----	----------	---

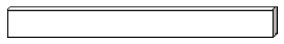

SSL/2100	2100	(-)	(-)	<b>4</b>	stormsierlat op het dak / latte de finition sur le toit
----------	------	-----	-----	----------	---



ZSL/3550	3550	(-)	(-)	<b>2</b>	ziersierlat tegen dakplanchet / finition latérale contre planchette du toit
----------	------	-----	-----	----------	--

DDC01-S/GH				<b>1</b>	opdekdeur classic voor slot / porte à recouvrement pour serrure
------------	--	--	--	----------	---

DDC01-V/GH				<b>1</b>	opdekdeur classic vast / porte à recouvrement fixe
------------	--	--	--	----------	--

A/DDO	(3 delen / 3 pièces)			<b>1</b>	kader 28mm voor dubbele opdekdeur / cadre 28mm pour porte double à recouvrement
-------	----------------------	--	--	----------	--

RV/DDC01				<b>1</b>	set raamverdeling / kit croisillons
----------	--	--	--	----------	-------------------------------------

A/EOR01L				<b>1</b>	buitenkader opengaand raam + raamverdeling / chassis extérieur fenêtre ouvrante + croisillons
----------	--	--	--	----------	--

EOR01L/GH				<b>1</b>	binnenkader opengaand raam + glas / chassis intérieur fenêtre ouvrante + verre
-----------	--	--	--	----------	---

B/3802				<b>1</b>	zak beslag / sachet quincaillerie
--------	--	--	--	----------	-----------------------------------

3184P/1-8				<b>6</b>	pakken shingles / paquets de bardeaux
-----------	--	--	--	----------	---------------------------------------

Onderdelenlijst  
Liste d'inventaire

Typ  
diamond **28mm 320x375 cm ZDVSP**

**3800AB375**

Artikel nr / Nr Article      Afmeting / Dimension      #      Functie / Fonction  
A      B      C

Wandelementen / Éléments des parois

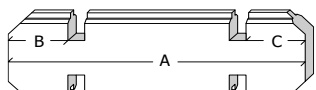

C3/3200/0100/0100	3200	100	100	<u>2</u>	zijgevel / paroi latérale
C3/3550/0100/0100	3550	100	100	<u>2</u>	voor- & achtergevel / paroi avant & arrière

Dakelementen / Éléments du toit

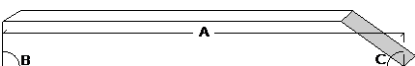

599917	126	90	53	<u>2</u>	dakbalksteun / échantignole
599918	526	90	53	<u>2</u>	buitenste hangstijl / contrefiche

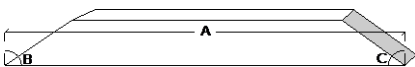

599920	1715	36	53	<u>2</u>	spantbeen / arbalétrier
--------	------	----	----	----------	-------------------------

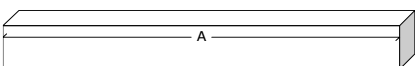

P1/1059	1059	95	44	<u>1</u>	middenste hangstijl / poinçon
P1/2944	2944	95	44	<u>1</u>	hanebalk / entrait
P4/3700	3700	120	44	<u>5</u>	dakbalk & ligger / panne et traverse

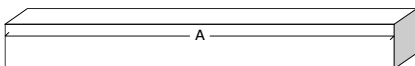

S088/088/2000	2000	90	90	<u>2</u>	paal / poteau
---------------	------	----	----	----------	---------------

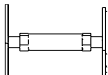

300035	290	(-)	(-)	<u>2</u>	U-anker / U-socle
--------	-----	-----	-----	----------	-------------------

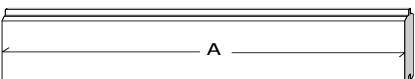

DP/2080	2080	(-)	(-)	<u>66</u>	dakplanchet / planchette du toit
---------	------	-----	-----	-----------	----------------------------------

Afwerkingselementen / Éléments de finition

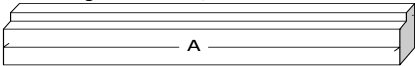

ZSL/3584	3584	(-)	(-)	<u>2</u>	zijsierlat tegen dakplanchet / finition latérale contre planchette du toit
----------	------	-----	-----	----------	---

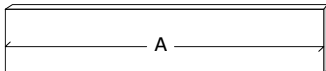

FSL/2400	2400	(-)	(-)	<u>2</u>	frontale sierlat / latte de finition frontale
----------	------	-----	-----	----------	---

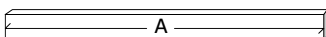

SSL/2400	2400	(-)	(-)	<u>2</u>	stormsierlat op het dak / latte de finition sur le toit
----------	------	-----	-----	----------	---

B/3800AB375				<u>1</u>	zak beslag / sachet quincaillerie
-------------	--	--	--	----------	-----------------------------------

3184P/1-8				<u>6</u>	pakken shingles / paquets de bardeaux
-----------	--	--	--	----------	---------------------------------------

# 28MM 355X320 CM ZDDDC01 (ART 3802)

**VOORZIJDE - FACADE**



**RUGZIJDE - PAROI ARRIERE**



**ZIJWAND - PAROI LATERALE**

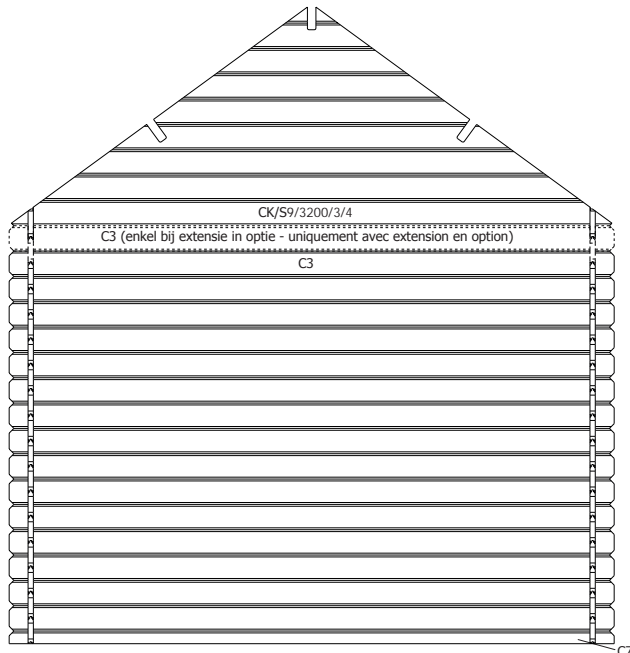

**ZIJWAND - PAROI LATERALE**

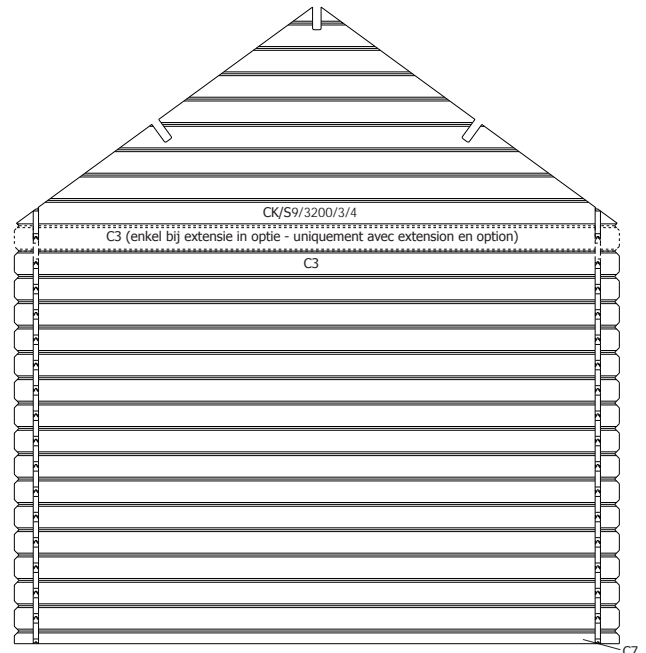

**DAK - TOITURE**

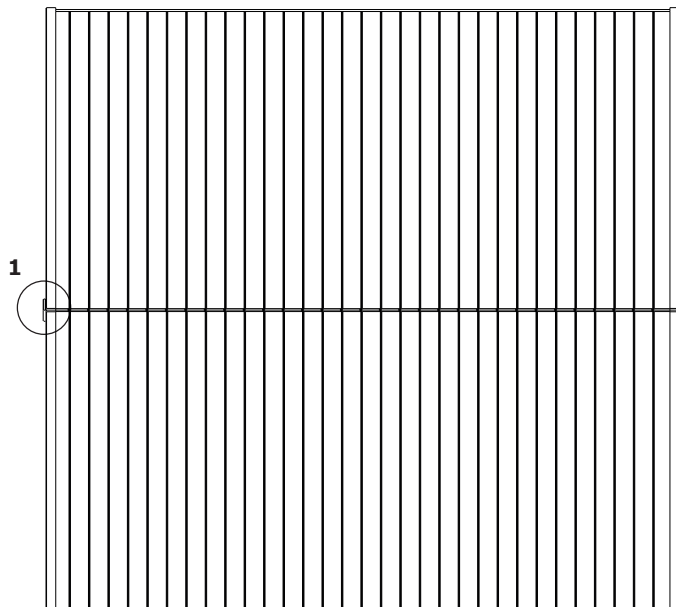
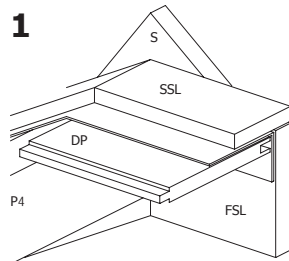

# 28MM 355X320 CM ZDVSP (ART3800AB375)

## ZIJAANZICHT - VUE LATERALE

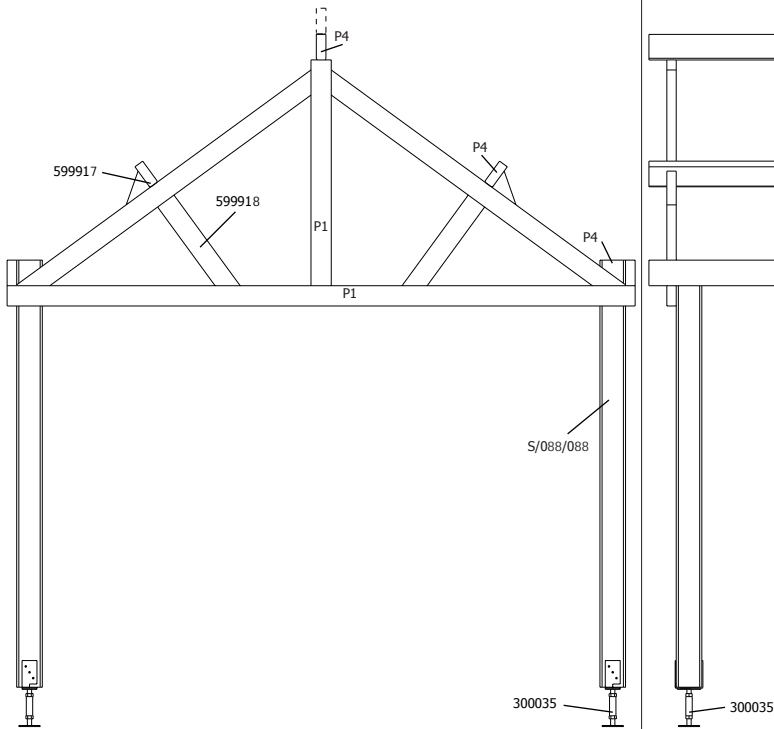

## VOORZIJDDE - FACADE

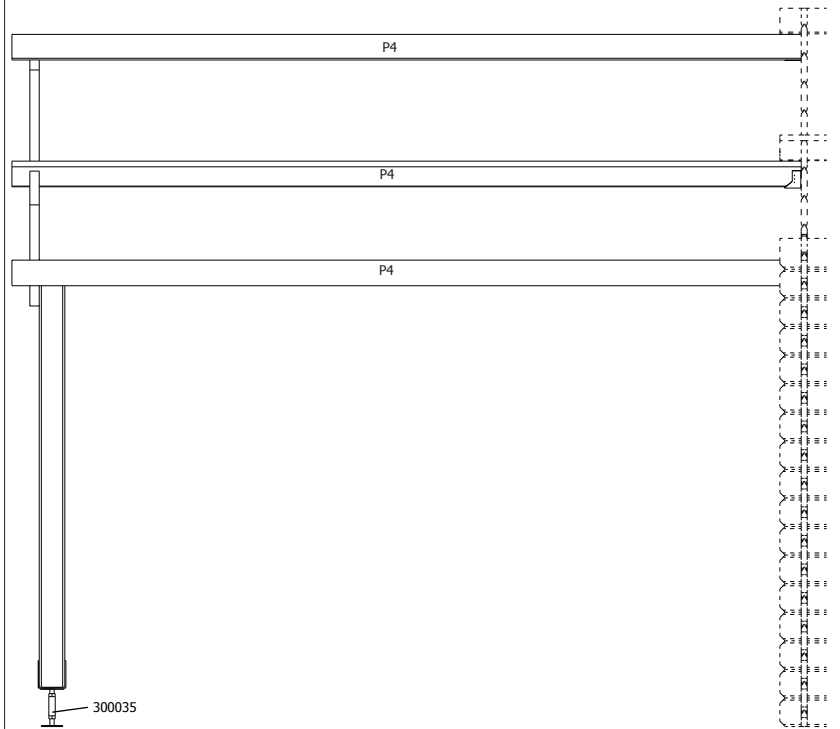

## DAK - TOITURE

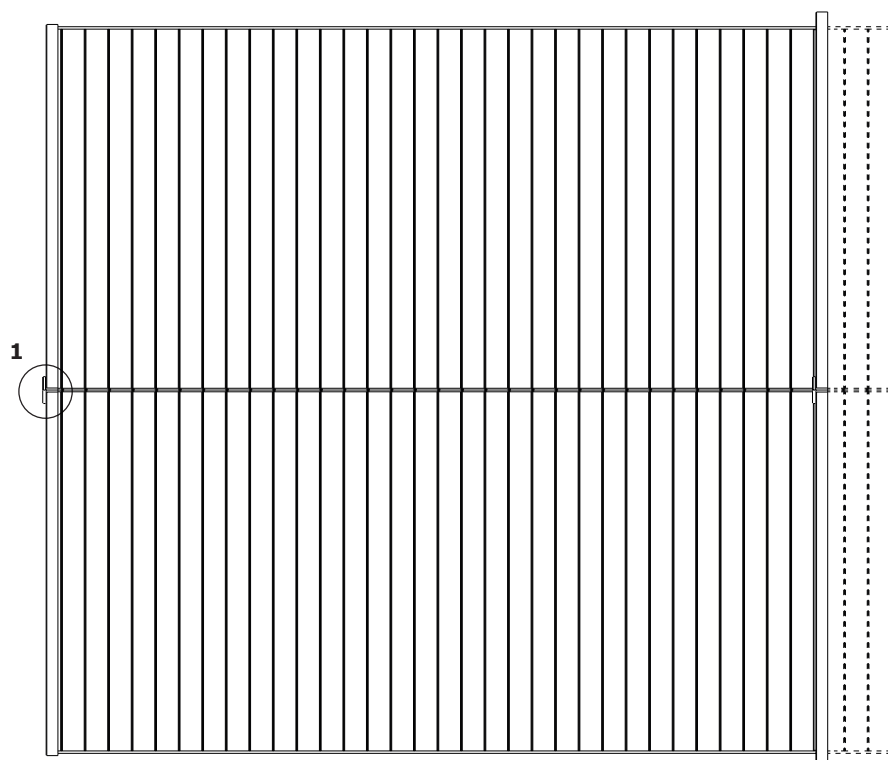
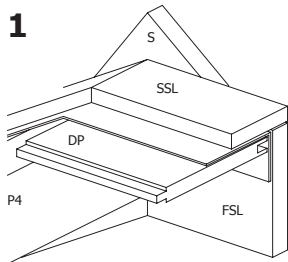

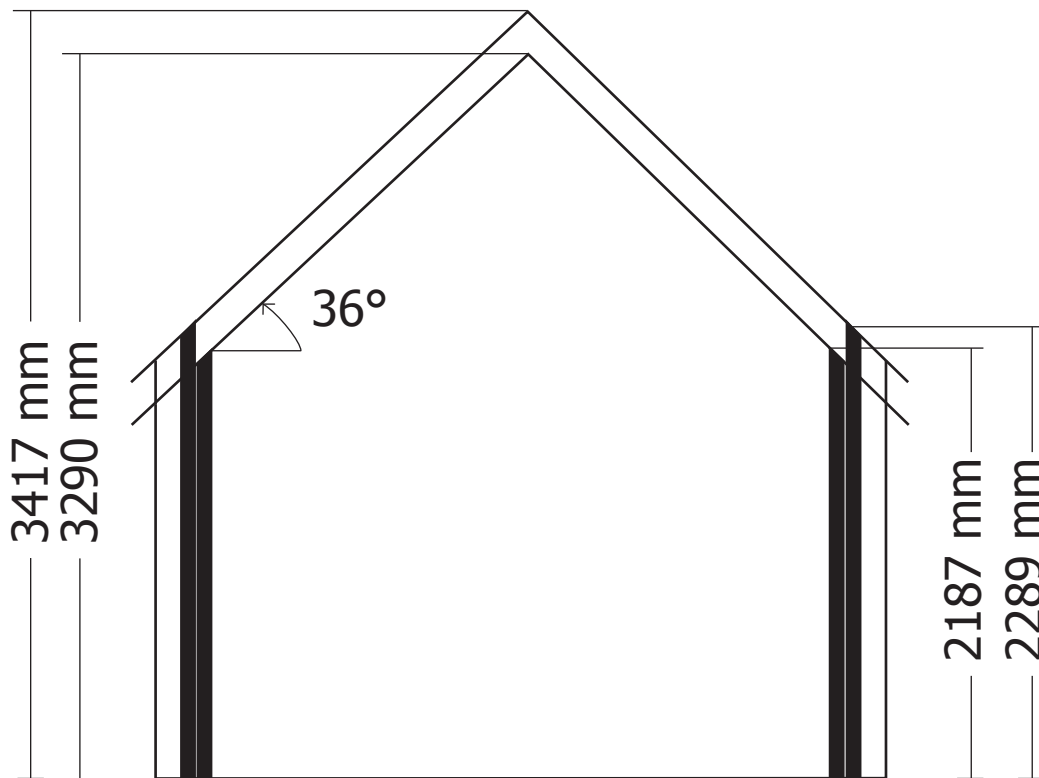
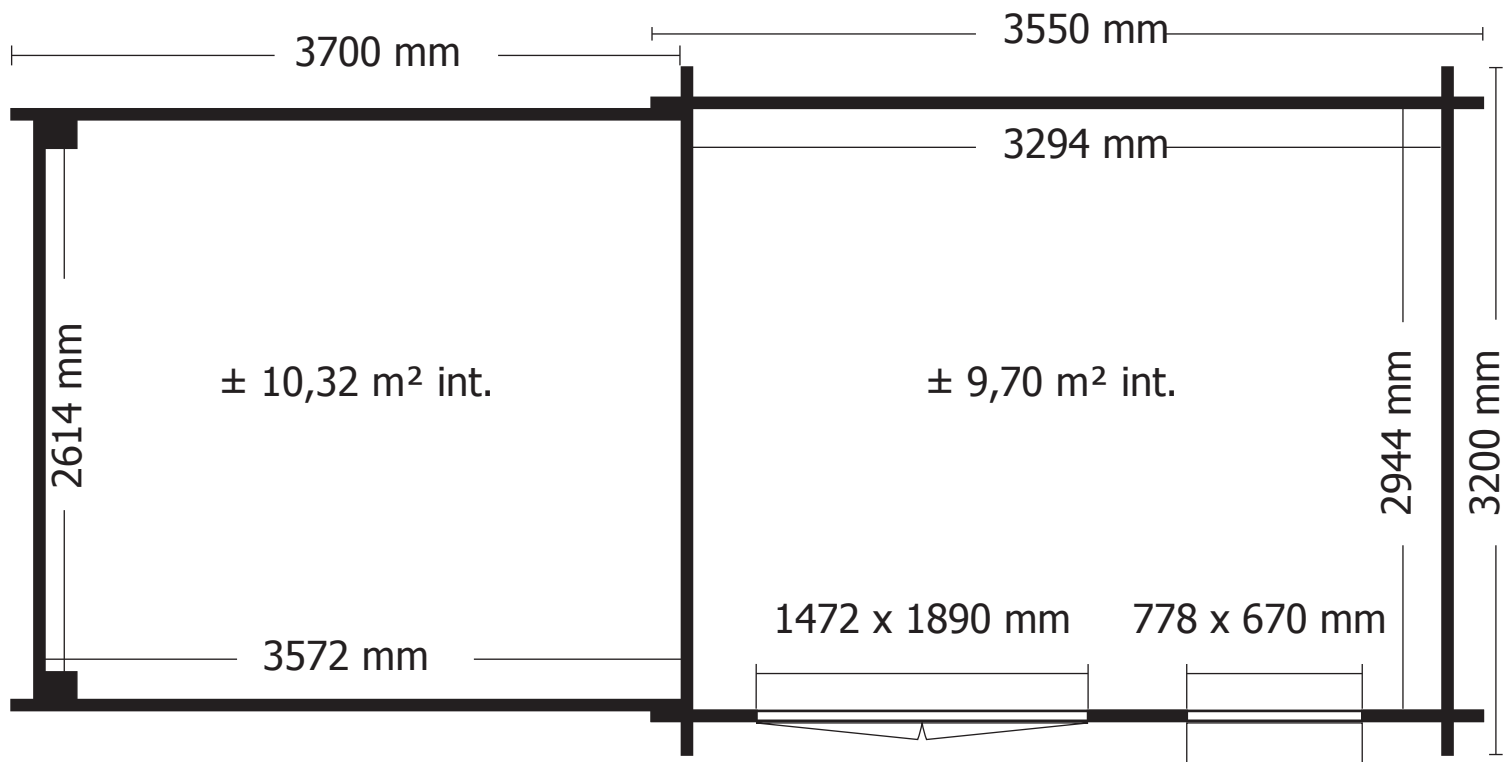

**OPGELET** : Behandel **ELK** onderdeel grondig aan alle zijden met een degelijk product dat beschermt tegen zon, weer en wind en tegen insecten en schimmels, **VOOR** de montage.

**ATTENTION** : Traitez à fond **CHAQUE** élément avec un produit protégeant contre les intempéries, les insectes et les moisissures intérieur et extérieur, **AVANT** le montage .

## B/3802

aantal / nombre

Slot - Serrure (leverlock)  
(Ref = 330003)



1

Scharnier paumelle groot - Charnière paumelle grand  
(Ref = 300014)

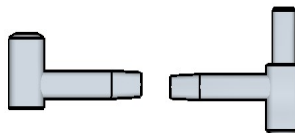

8 set

Scharnier paumelle klein - Charnière paumelle petit  
(Ref = 300013)

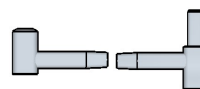

2 set

Raamuitzetter wit - Entrebâilleur blanc  
(Ref = 300009)

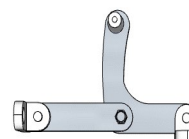

1

Kantschuif - Pêne (120mm)  
(Ref = 300019)



2

Hoekijzer groot - Equerre grand (60x60x40)  
(Ref = 300024)

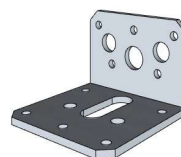

2

Schildje - Ecusson  
(Ref = 5)



2

### Nagels - Clous

2,5x50mm  
(Ref = 361002)



1 x 500

3x14mm  
(Ref = 362001)



1 x 300 g

### Schroeven - Vis

25mm  
(Ref = 310018)



30

35mm  
(Ref = 310007)



32

70mm  
(Ref = 310009)

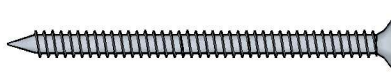

46

## B/3800AB375

aantal / nombre

Hoekijzer klein - Equerre petit (30x30x30)  
(Ref = 300026)

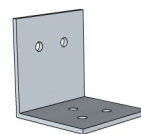

2

Balkdrager rechts - Support de poutre droite  
(Ref = 300033)

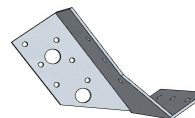

2

Balkdrager links - Support de poutre gauche  
(Ref = 300034)



1

Rondel - Rondelle (M8)  
(Ref = 330001)



16

Houtdraadbout - Boulon (8x70)  
(Ref = 340001)

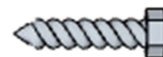

8

Houtdraadbout - Boulon (7x90)  
(Ref = 340003)



8

Half schildje - Demi écusson  
(Ref = S)



1

### Nagels - Clous

2,5x50mm  
(Ref = 361001)



1 x 750

3x14mm  
(Ref = 362001)



2 x 300 g

### Schroeven - Vis

25mm  
(Ref = 310018)



29

35mm  
(Ref = 310007)



24

70mm  
(Ref = 310009)



8

100mm  
(Ref = 310005)



16